



PUMA 2022 TEAM SOCCER

FOREVER **FASTER.**



07 - MATCH DAY

26 - BASELAYERS

30 - BAGS

37 - TRAINING

47 - COACHES

56 - SIDELINE

66 - EQUIPMENT

Clubs



Olympique Marseille



Palmeiras



AC Milan



Manchester City



Borussia Dortmund



C.D. Guadalajara



Valencia CF



Federations



Austria



Czech Republic



Iceland



Italy



Israel



Serbia



Switzerland



Egypt



Ghana



Ivory Coast



Morocco



Senegal



Uruguay



Global League Partners





USL Championship

Indy Eleven



Oakland Roots



New Mexico United



FC Tulsa



San Antonio FC



Monterey Bay FC



RGV FC Toros



Austin Bold



US Soccer Partnerships





MATCHDAY



ULTRAWEAVE



ULTRAWEAWE



LIGHT FABRIC



LESS SEAMS

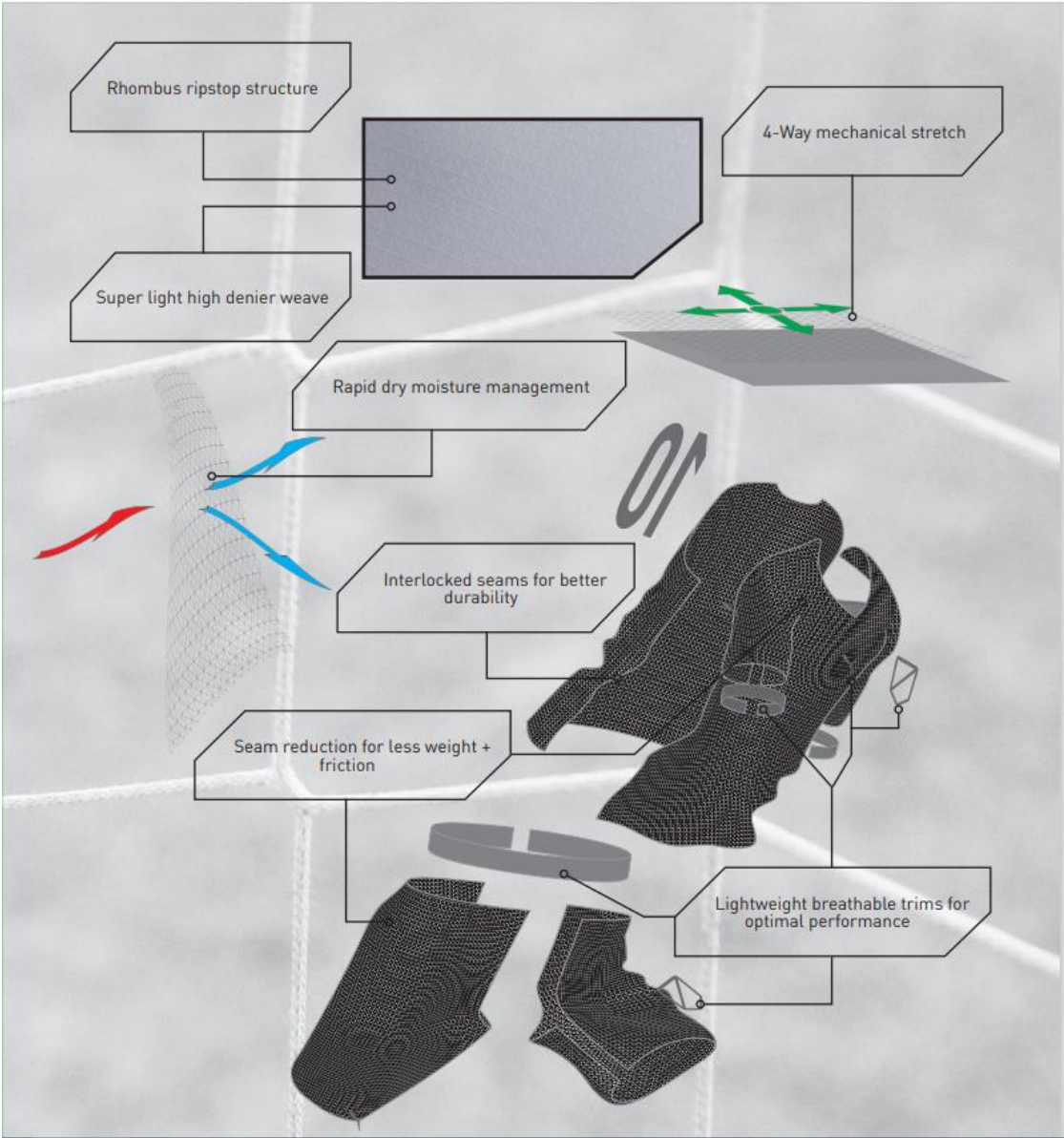

TEAM FINAL Jersey

Ultraweave engineered fabrication, provides a super light-weight , comfortable performance jersey with a rapid moisture management system and multi directional stretch for maximum movement. Heat transfer PUMA Cat branding on right chest and both sleeves.

Pro Fit. dryCELL.

100% polyester- bio-based wicking finish

NEW

SS22

01



Start:01/01/2022 End : Spring 2024	STYLE NUMBER	MSRP*
Men's (S-XXL)	705016	\$60
Youth (S-XL)	705308	\$60

Col	Description
01	Puma Red-Rio Red
02	Electric Blue Lemonade-Limoges
03	Puma Black-Phantom Black
04	Puma White-Nimbus Cloud
06	Peacoat-Puma New Navy
07	Cyber Yellow-Freesia

02



03



04



06



07



TEAM FINAL Shorts

Ultraweave engineered fabrication, provides a super light-weight , comfortable performance short with multi directional stretch for maximum movement. Heat transfer PUMA Cat branding on left leg. Pro Fit. dryCELL.

100% polyester: bio-based wicking finish

NEW

SS22

Start:01/01/2022
End : Spring 2024

STYLE
NUMBER

MSRP*

Men's (S-XXL)

705076

\$30

Youth (S-XL)

705310

\$30

01



Col

Description

01

Puma Red-Rio Red

02

Electric Blue Lemonade-Limoges

03

Puma Black-Phantom Black

04

Puma White-Nimbus Cloud

06

Peacoat-Puma New Navy

07

Cyber Yellow-Freesia

02



03



04



06



07



TEAM CUP Jersey

Performance engineered short sleeve jersey , with maximum breathability and high stretch for maximum movement and comfort. Heat transfer PUMA Cat branding on right chest and both sleeves. Pro Fit. dryCELL.

100% polyester-double knit-finish: bio-based wicking finish

Start:03/01/2021 End : December 2022	STYLE NUMBER	MSRP*
Men's (S-XXL)	704386	\$45
Youth (S-XL)	704387	\$45
Women's (XXS-XL)	705081	\$45

Col	Description
01	Puma Red
02	Electric Blue Lemonade
03	Puma Black
04	Puma White

SS22

01



02



03



04



TEAM GLORY Jersey

Sublimated chevron graphic on front . Short Sleeve performance jersey. Heat Transfer PUMA Cat branding on right chest and both sleeves. Pro Fit. dryCELL.

100% polyester-double knit-finish: bio-based wicking finish

Start:01/01/2022 End : Spring 2025	STYLE NUMBER	MSRP*
Men's (S-XXL)	705017	\$40
Youth (S-XL)	705309	\$40
Women's (XS-XL)	705347	\$40

Col	Description
01	Puma Red
02	Electric Blue Lemonade
03	Puma Black
04	Puma White
05	Pepper Green
06	Peacoat
18 #	Team Light Blue
20	Fizzy Lime
21	Neon Citrus
22	Yellow Alert
24	Grape Wine

NEW

02



SS22

01



03



04



05



06



18



20



21



22



24



TEAM FINAL 21 Graphic Jersey

Sublimated hexagon graphic on front. New shoulder panel construction for enhanced movement. Ribbed V Neck. Heat transfer PUMA Cat branding on right chest and both sleeves. Pro Fit. dryCELL.

100% polyester-double knit-finish: bio-based wicking finish-140.00 g/m²

Start:01/20/20 End:December2022	STYLE NUMBER	MSRP*
Men's (S-XXL)	704150	\$40
Youth (S-XL)	704369	\$40
Women's (XXS-XL)	704368	\$40

Col	Description
01	Puma Red-Chili Pepper
02	Electric Blue Lemonade-Team Power Blue
03	Puma Black-Asphalt
04	Puma White-Gray Violet
05	Pepper Green-Power Green
06	Peacoat-Limoges
07	Cyber Yellow-Spectra Yellow
13	Steel Gray-Puma Black
18	Team Light Blue-Blue Yonder
21	Green Glimmer-Aqua Green
22	Pink Glimmer-Beetroot Purple

01



SS22

02



03



04



05



06



07



13



18



21



22



TEAM FINAL 21 Shorts

Premium waist band for improved fit and comfort. New tonal side panel construction enhances movement. Heat transfer PUMA Cat branding on left leg. Regular Fit. dryCELL.

100% polyester-double knit-finish: bio-based wicking finish-140.00 g/m²

Start:01/20/20 End:December2022	STYLE NUMBER	MSRP*
Men's (S-XXL)	704257	\$26
Youth (S-XL)	704371	\$26
Women's (XXS-XL)	704370	\$26

Col	Description
01	Puma Red-Chili Pepper
02	Electric Blue Lemonade-Team Power Blue
03	Puma Black-Asphalt
04	Puma White-Gray Violet
05	Pepper Green-Power Green
06	Peacoat-Limoges
07	Cyber Yellow-Spectra Yellow
13	Steel Gray-Puma Black
18	Team Light Blue-Blue Yonder
21	Green Glimmer-Aqua Green
22	Pink Glimmer-Beetroot Purple

01



02



03



04



05



06



07



13



18



21



22



SS21



TEAM LIGA 25 STRIPE Jersey

A new take on stripes !

Striped front with mesh inserts for enhanced breathability , plain back. A tailored crew neck. Heat Transfer PUMA Cat branding on the center of the chest. Regular Fit. dryCELL.

100% polyester-double knit-finish

Start:05/01/2021 End : Spring 2025	STYLE NUMBER	MSRP*
Men's (S-3XL)	704920	\$35
Youth (XXS-XL)	704927	\$35

Col	Description
01	Puma Red-Puma Black-Puma White
02	Electric Blue-Puma Black-Puma White
04	Puma White-Puma Black
07	Cyber Yellow-Puma Black

SS22

04



01



02



07



TEAM LIGA 25 Jersey

Dynamic cut front panel with mesh inserts on the shoulder. Plain back. Mesh trims on the cuffs, back of the neck and rear hem wrapping around to the front. Crew Neck. Heat Transfer PUMA Cat branding on right chest. Regular Fit. dryCELL.

100% polyester-double knit-finish, bio based wicking finish

Start:05/01/2021 End : Spring 2025	STYLE NUMBER	MSRP*
Men's (S-3XL)	704917	\$30
Youth (XXS-XL)	704925	\$30
Women's (XXS-XL)	704934	\$30

Col	Description
01	Puma Red-Puma White
02	Electric Blue Lemonade-Puma White
03	Puma Black-Puma White
05	Pepper Green-Puma White
06	Peacoat-Puma White
07	Cyber Yellow-Puma Black
09 #	Cordovan-Puma White
10 #	Prism Violet-Puma White
13	Smoked Pearl-Puma White
14	Puma White-Puma White

- N/A in women's

SS22



TEAM LIGA 25 Shorts

Elasticated Waistband with Drawcord. Two side vertical mesh inserts aid movement and breathability. Heat transfer PUMA Cat branding on left leg. Regular fit. dryCELL.

100% polyester-double knit-finish.

SS22

Start:05/01/2021 End : Spring 2025	STYLE NUMBER	MSRP*
Men's (S-3XL)	704924	\$24
Youth (XXS-XL)	704931	\$24
Women's (XXS-XL)	704936	\$24

Col	Description
01	Puma Red-Puma White
02	Electric Blue Lemonade-Puma White
03	Puma Black-Puma White
04	Puma White-Puma Black
05	Pepper Green-Puma White
06	Peacoat-Puma White
07	Cyber Yellow-Puma Black
09#	Cordovan-Puma White
13#	Smoked Pearl-Puma White
20#	Fizzy Lime-Puma Black
21#	Neon Citrus-Puma Black
22#	Yellow Alert-Puma Black
24#	Grape Wine-Puma White

02



01



03



04



05



06



07



09#



13#



20#



21#



22#



24#



- N/A in women's

TEAM GOAL 23 Jersey

Dynamic inverted two-part side panel with breathable mesh top part and contrasted bottom shell insert enhances movement. Shoulder and back panel in mesh for breathability. Contrasted collar and cuffs. Crew Neck. Heat Transfer PUMA Cat branding on right chest. Regular Fit. dryCELL.

100% polyester-double knit-finish: bio-based wicking finish-137.00 g/m²

Start:01/20/20 End : Spring 2024	STYLE NUMBER	MSRP*
Men's (S-XXL)	704171	\$28
Youth (S-XL)	704160	\$28
Women's (XXS-XL)	704378	\$28

Col	Description
01	Puma Red-Chili Pepper
02	Electric Blue Lemonade-Team Blue
03	Puma Black-Asphalt
05	Pepper Green-Power Green
06	Peacoat-Puma New Navy
07	Cyber Yellow-Spectra Yellow
13	Steel Gray-Puma Black
14	Puma White-Puma White
23	Fluo Yellow-Puma Black
24	Shocking Orange-Puma Black
25	Fluo Pink-Puma Black

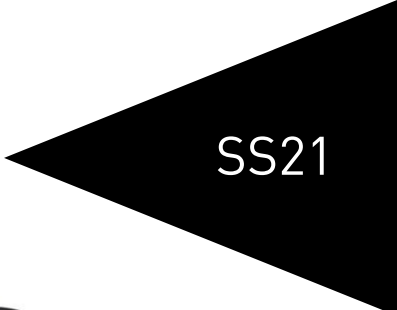

TEAM GOAL 23 Shorts

Elasticated Waistband with Drawcord. Two-part side panel with mesh bottom half aids movement and breathability. Heat transfer PUMA Cat branding on left leg. Regular fit. dryCELL.

100% polyester-double knit-finish: bio-based wicking finish-137.00 g/m²

Start:01/20/20 End : Spring 2024	STYLE NUMBER	MSRP*
Men's (S-XXL)	704262	\$24
Youth (S-XL)	704263	\$24
Women's (XXS-XL)	704379	\$24

Col	Description
01	Puma Red
02	Electric Blue Lemonade
03	Puma Black
04	Puma White
05	Pepper Green
06	Peacoat
13	Steel Gray
23	Fluo Yellow-Puma Black
24	Shocking Orange-Puma Black
25	Fluo Pink-Puma Black

SS22

13



TEAM RISE Jersey

Crew neck. Plain front and back. Monochrome mesh trims on the cuffs, Heat Transfer PUMA Cat branding on center of chest. Regular Fit. dryCELL.

100% polyester-double knit-finish

Start:05/01/2021
End : Spring 2025

STYLE NUMBER

MSRP*

Men's (S-3XL)

704932

\$18

Youth (XXS-XL)

704938

\$18

Col

Description

01 Puma Red-Puma Black-Puma White

02 Electric Blue Lemonade-Black-White

03 Puma Black-Smoked Pearl-Puma White

04 Puma White-Puma Black-Puma White

05 Pepper Green-Puma Black-Puma White

06 Peacoat-Puma Black-Puma White

07 Cyber Yellow-Puma Black-Puma White

08 Golden Poppy-Puma Black-Puma White

09 Cordovan-Puma Black-Puma White

10 Prism Violet-Puma Black-Puma White

13 Smoked Pearl-Puma Black-Puma White

18 Team Light Blue- Black-White

SS22

03



01



02



04



05



06



07



08



09



10



13



18



TEAM RISE Shorts

Elasticated waistband with drawcord. Heat transfer PUMA Cat branding on left leg. Regular fit. dryCELL.

100% polyester.

Start:05/01/2021
End : Spring 2025

**STYLE
NUMBER**

MSRP*

Men's (S-3XL)

704942

\$16

Youth (XXS-XL)

704943

\$16

Col

Description

01 Puma Red-Puma White

02 Electric Blue Lemonade-Puma White

03 Puma White-Puma Black

04 Puma Black-Puma White

05 Pepper Green-Puma White

06 Peacoat-Puma White

07 Cyber Yellow-Puma Black

08 Golden Poppy-Puma Black

09 Cordovan-Puma Black-Puma White

10 Prism Violet-Puma White

13 Smoked Pearl-Puma White

18 Team Light Blue-Puma White

04



01



02



03



05



06



07



08



09



10



13



18



SS22

TEAM PACER GK Jersey

Long sleeve, crew necked GK jersey with raglan sleeves for unrestricted arm movement. Front mesh insert panels for enhanced breathability Heat Transfer PUMA Cat branding on right chest. Regular Fit. dryCELL.

100% polyester-double knit-finish: bio-based wicking finish

Start:05/01/2021 End : Spring 2025	STYLE NUMBER	MSRP*
Men's (S-3XL)	704933	\$35
Youth (S-XL)	704939	\$35

Col	Description
40	Blue Atoll-Puma Black-Puma White
42	Fluo Yellow-Puma Black-Puma White

40



42



SS22

TEAM LIGA Sock

PUMA Cat Branding, knitted to sock front. Contrast color welt. Knitted mesh for breathability. Cotton heel and toe for comfort. Ankle brace for stability. R&L anatomically knitted foot-bed for Left & Right size. 87% Polyester, 12% Polypropylene, 1% Elastane

SS22

STYLE NUMBER	703438	MSRP \$12
S	13-3 shoe size	
M	3.5-6 shoe size	
L	7-9 shoe size	
XL	10-12 shoe size	

Col	Description
01	Puma Red-Puma White
02	Electric Blue Lemonade-Puma White
03	Puma Black-Puma White
04	Puma White-Puma Black
05	Pepper Green-Puma White
06	Peacoat-Puma White
07	Cyber Yellow-Puma Black
08	Golden Poppy-Puma Black
09	Cordovan-Puma White
10	Prism Violet-Puma White
13	Steel Gray-Puma Black
18	Silver Lake Blue-Puma White



LIGA Base Layer Long Sleeve Top

PUMA Cat logo on chest; Light compression apparel: next to skin layers are designed to work with your body's natural systems to help you to enhance and maximize your performance. Elastane content provides long lasting elasticity for enhanced freedom of movement. Slim Fit. dryCELL.

11% spandex, 89% polyester-jersey-wicking: 170.00 g/m²

Start:01/20/2020
End :

STYLE
NUMBER

MSRP*

Men's (S-XXL)

655920

\$40

Youth (M-XL)

655921

\$40

Col

Description

03

Puma Black

04

Puma White

03



04



SS22

LIGA Base Layer Long Tight

PUMA Cat branding, Heat Transfer on left leg; Light compression apparel: next to skin layers are designed to work with your body's natural systems to help you to enhance and maximize your performance. Elastane content provides long lasting elasticity for enhanced freedom of movement. Slim Fit. dryCELL.

88% polyester 12% elastane -jersey-wicking:185.00 g/m²

Start:01/20/2020 End :	STYLE NUMBER	MSRP*
Men's (S-XXL)	655925	\$40
Youth (M-XL)	655945	\$40

Col	Description
03	Puma Black



03

SS21

LIGA Base Layer Short Sleeve Top

PUMA Cat logo on chest; Light compression apparel: next to skin layers are designed to work with your body's natural systems to help you to enhance and maximize your performance. Elastane content provides long lasting elasticity for enhanced freedom of movement. Slim Fit. dryCELL.

11% spandex, 89% polyester-jersey-wicking: 170.00 g/m²

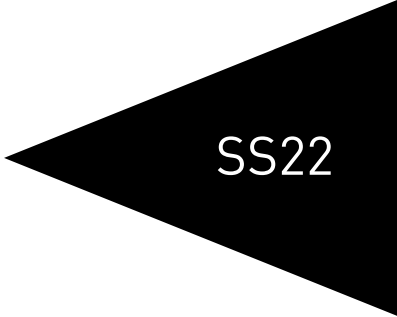

SS22

Start:01/20/2020
End :

**STYLE
NUMBER**

MSRP*

Men's (S-XXL)

655918

\$30

Youth (M-XL)

655919

\$30

Col

Description

01

Puma Red

02

Electric Blue Lemonade

03

Puma Black

04

Puma White

01



02



03



04



LIGA Base Layer Short Tight

PUMA Cat branding, Heat Transfer on left leg; Light compression apparel: next to skin layers are designed to work with your body's natural systems to help you to enhance and maximize your performance. Elastane content provides long lasting elasticity for enhanced freedom of movement. Slim Fit. dryCELL.

88% polyester 12% elastane -jersey-wicking:185.00 g/m²

Start:01/20/2020
End :

STYLE
NUMBER

MSRP*

Men's (S-XXL)

655924

\$30

Youth (M-XL)

655937

\$30

Col

Description

01

Puma Red

02

Electric Blue Lemonade

03

Puma Black

04

Puma White



01



04



02



03

SS22

TEAM FINAL Teambag

Premium Teambag. One main compartment; Front Zipped pocket; One end side pocket. Puma Cat branding on front and on shoulder strap

100% Polyester

NEW

SS22

Start:01/01/2022

**STYLE
NUMBER**

MSRP*

078940

\$55

Col

Description

01

Puma Black-Medium Gray Heather



TEAM FINAL Backpack

One main compartment; One Front compartment . Front zipped pocket

100% Polyester

NEW

SS22

Start:01/01/2022

STYLE
NUMBER

MSRP*

079054

\$50

Col

Description

01

Puma Black-Medium Gray Heather



TEAM GOAL 23 Backpack

One main compartment; Bottom ball compartment; Front Zipped pocket; two side mesh pocket. Pigment print Cat branding.

100% Polyester

STYLE NUMBER	MSRP*
077017	\$55

Col	Description
01	Puma Red-Puma Black
02	Electric Blue Lemonade-Puma Black
03	Puma Black
04	Steel Gray
05	Puma New Navy

SS22



TEAM GOAL 23 Medium Bag

Water repellent bottom and front panel; U shape opening; Side zipped pocket with laser cut bonded holes; Front zipped pocket; Side mesh compartment; Side small pocket for valuables; Removable shoulder strap; Pigment print Cat branding.

100% Polyester

STYLE NUMBER	MSRP*
077018	\$45

Col	Description
01	Puma Red-Puma Black
02	Electric Blue Lemonade-Puma Black
03	Puma Black
04	Steel Gray
05	Puma New Navy

01



SS22

02



03



04

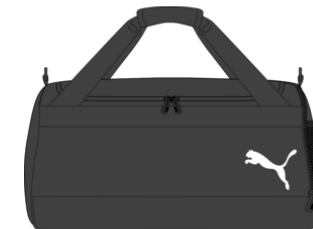

05



TEAM FINAL 21 Gym Sack

Ripstop front material; One main compartment; Side Zipped pocket; Pigment print Cat branding

100% Polyester

STYLE
NUMBER

MSRP*

076580

\$15

Col

Description

01

Puma Red-Puma Black

02

Electric Blue Lemonade-Puma Black

03

Puma Black

01



02



03



SS22

TEAM GOAL 23 Shoe Bag

One main zipped compartment.

100% Polyester

NEW

SS22

STYLE
NUMBER

MSRP*

076864

\$15

Col

Description

03

Puma Red-Puma Black



TEAM LIGA 21 Winter gloves

Fleece players gloves , with silicon infused fingertip grip zones

100% Polyester

NEW

SS22

	STYLE NUMBER	MSRP*
--	--------------	-------

S/M/L	041706	\$18
-------	--------	------

Col	Description
-----	-------------

01	Puma Black
----	------------





TRAINING

TEAM LIGA 25 Training Jacket

Bold main color blocking on front and back with contrast black sleeves.
 Reversed full coil zip. Two side zipped pockets.
 Heat transfer PUMA Cat branding on right chest. Regular Fit. dryCELL.

100% polyester-double knit-finish: bio-based wicking finish.

Start:05/01/2021 End : Spring 2025	STYLE NUMBER	MSRP*
Men's (S-XXL)	657234	\$55
Youth (S-XL)	657235	\$55
Women's (XS-XL)	657252	\$55

Col	Description
01	Puma Red-Puma Black
02	Electric Blue Lemonade-Puma Black
03	Puma Black-Puma White
05	Pepper Green-Puma Black
06	Peacoat-Puma White
13	Smoked Pearl-Puma White

SS22



TEAM LIGA 25 ¼ Zip Top

Bold main color blocking on front and back with black sleeves and contrast colored cuff thumb holes. Mesh insert on the front of the shoulder's for enhanced breathability .Reversed 1/4 zip.
Heat transfer PUMA Cat branding on right chest. Regular Fit. dryCELL.

100% polyester-double knit-finish: bio-based wicking finish.

Start:05/01/2021
End : Spring 2025

STYLE
NUMBER

MSRP*

Men's (S-XXL)

657236

\$50

Youth (S-XL)

657237

\$50

Women's (XS-XL)

657253

\$50

Col

Description

01

Puma Red-Puma Black

02

Electric Blue Lemonade-Puma Black

03

Puma Black-Puma White

05

Pepper Green-Puma Black

06

Peacoat-Puma White

13

Smoked Pearl-Puma White

SS22



TEAM GOAL 23 Training Jacket

Contrast color blocking on shoulders and on front and back lower. Reversed full coil zip. 2 side zipped pockets. Elasticated cuffs and hem. Pigment print PUMA Cat branding on right chest. Regular Fit. dryCELL.

100% polyester-double knit-finish: bio-based wicking finish-140.00 g/m²

Start:01/20/20
End : Spring 2024

**STYLE
NUMBER**

MSRP*

Men's (S-XXL)

656561

\$60

Youth (S-XL)

656570

\$60

Women's (XS-XL)

656939

\$60

Col

Description

01

Puma Red-Chili Pepper

02

Electric Blue Lemonade-Team Blue

03

Puma Black-Asphalt

05

Pepper Green-Power Green

06

Peacoat-Puma New Navy

13

Steel Gray-Asphalt



SS21

01



03



05



06



13



TEAM GOAL 23 Training ¼ Zip Top Jacket

Contrast color blocking on shoulders and on front and back lower. Hidden 1/4 zip. Structure fabric on front and back. Pigment print PUMA Cat branding on right chest. Regular fit. dryCELL.

100% polyester-double knit-brushed: back finish: bio-based wicking finish-230.00 g/m²

Start:01/20/20 End : Spring 2024	STYLE NUMBER	MSRP*
Men's (S-XXL)	656476	\$55
Youth (S-XL)	656567	\$55

Col	Description
01	Puma Red-Chili Pepper
02	Electric Blue Lemonade-Team Blue
03	Puma Black-Asphalt
05	Pepper Green-Power Green
06	Peacoat-Puma New Navy
13	Steel Gray-Asphalt

13



SS22

01



02



03



05



06



TEAM GOAL 23 Training Jersey

Contrast color blocking on shoulders and on front and back lower half. Mesh fabric back for breathability. Crew Neck. Pigment print PUMA Cat branding on right chest. Regular Fit. dryCELL.

100% polyester-double knit-finish: bio-based wicking finish-140.00 g/m²

Start:01/20/20 End : Spring 2024	STYLE NUMBER	MSRP*
Men's (S-XXL)	656482	\$30
Youth (S-XL)	656569	\$30

Col	Description
01	Puma Red-Chili Pepper
02	Electric Blue Lemonade-Team Blue
03	Puma Black-Asphalt
05	Pepper Green-Power Green
06	Peacoat-Puma New Navy
13	Steel Gray-Asphalt

01



SS22

02



03



05



06



13



TEAM LIGA 25 Training Pants Pro

PUMA Cat pigment print branding on left leg; with gusset visible; anatomical patterns; grown on waistband with drawcord; 2 side zipped pockets. Slim Tapered Fit. dryCELL.

90% polyester, 10% elastane; french terry; 230.00 g/m²

Start:05/01/2021
End : Spring 2025

STYLE
NUMBER

MSRP*

Men's (S-XXL)

657332

\$55

Col

Description

03

Puma Black-Puma White



03

SS22

TEAM LIGA 25 Training Pants

Elasticated Waistband with Drawcord. Two side zipped pockets. Vertical mesh inserts on the side of calf with lower leg zip opening aids movement and breathability. Heat transfer PUMA Cat branding on left thigh. Regular fit. dryCELL.

100% polyester-double knit-finish: bio-based wicking finish.

Start:05/01/2021
End : Spring 2025

**STYLE
NUMBER**

MSRP*

Men's (S-XXL)

657242

\$45

Youth (S-XL)

657243

\$45

Women's (XS-XL)

657254

\$45

Col

Description

03

Puma Black-Puma White

06

Peacoat-Puma White



06



03

SS22

TEAM LIGA 25 Training ¾ Pants

Elasticated Waistband with Drawcord. Two side pockets. Vertical mesh inserts on the side of the hip aids breathability. Heat transfer PUMA Cat branding on left thigh. Regular fit. dryCELL.

100% polyester-double knit-finish: bio-based wicking finish.

Start:05/01/2021
End : Spring 2025

STYLE NUMBER

MSRP*

Men's (S-XXL)

657271

\$35

Youth (S-XL)

657244

\$35

Col

Description

03

Puma Black-Puma White

06

Peacoat-Puma White



06



03

SS22

BIB

Large PUMA Cat Brandings front and back. Mesh body relaxed fit for ease of use over training garments.

100% polyester; mesh; 70.00 g/m²

Start:01/07/2021
End :

STYLE
NUMBER

MSRP*

S/M/XL

657251

\$8

Col

Description

04

Puma White

41

Blue Atoll

42

Fluo Yellow

04



41



42



SS22



COACHES

Bench Jacket (full length)

Classic full length Bench jacket with hood. Elasticated cuff. Full length coil zip .
Two side zipped pockets. PUMA cat logo on right chest.
Regular fit.

100% Polyester-twill-down-proof.

Start:05/01/2021 End : Spring 2025	STYLE NUMBER	MSRP*
Men's (S-3XL)	657268	\$100
Youth (M-XL)	657269	\$100

Col	Description
03	Puma Black-Puma White

03



SS22

TEAM LIGA Vest

Padded vest , with two side zipped pockets
PUMA cat logo on right chest.
Regular fit.

100% Polyester-twill-down proof.

NEW

SS22

Start:01/01/2022
End : Spring 2025

STYLE
NUMBER

MSRP*

Men's (S-XXL)

657968

\$65

Col

Description

03

Puma Black

06

Peacoat

03



06



TEAM CUP Casuals Hooded Jacket

Premium hooded jacket , with engineered honeycombed panels on the hood, arms and side for maximum movement and enhanced breathability. Reversed full coil zip . Two side zipped pockets . Draw cord closure on hood. Cuffed sleeves.

High quality silicon PUMA cat logo on right chest. Regular fit.

78% cotton,18%polyester,4% Elastane.

Start:05/01/2021
End : Spring 2023

STYLE
NUMBER

MSRP*

Men's (S-XXL)

656748

\$70

Col

Description

03

Puma Black

06

Peacoat

33

Medium Gray Heather



06



33



SS22

TEAM CUP Casual Pants

Cotton casual shorts, with mesh insert panels around the waist and on the bottom of the leg for added comfort and breathability.
Elasticated Waistband with Drawcord. Two side zipped pockets.
Silicon PUMA Cat branding on left thigh.
Regular fit.

78% cotton,18%polyester,4% Elastane.

Start:05/01/2021
End : Spring 2023

STYLE
NUMBER

MSRP*

Men's (S-XXL)

656751

\$50

Col

Description

03

Puma Black



03

SS21

TEAM CUP Casual Shorts

Cotton casual jog , with mesh insert panels around the waist and on the back of the calf for added comfort and breathability.
Elasticated Waistband with Drawcord. Two side zipped pockets.
Silicon PUMA Cat branding on left thigh.
Regular fit.

78% cotton,18%polyester,4% Elastane.

Start:05/01/2021
End : Spring 2023

STYLE
NUMBER

MSRP*

Men's (S-XXL)

656750

\$35

Col

Description

03

Puma Black



03

SS22

TEAM LIGA 25 Sideline Polo

Classic short sleeve Polo . PUMA Cat branding on right chest. Regular Fit. dryCELL.

100% polyester-double knit-finish: bio-based wicking finish

Start:05/01/2021
End : Spring 2025

**STYLE
NUMBER**

MSRP*

Men's (S-XXL)

657257

\$35

Women's (XXS-XL)

657408

\$35

Col

Description

01

Puma Red-Puma White

02

Electric Blue Lemonade-Puma White

03

Puma Black-Puma White

04

Puma White-Puma Black

06

Peacoat

01



SS22

02



03



04



06



TEAM LIGA 25 Training (Coaches) Shorts

Elasticated Waistband with Drawcord. Two side vertical mesh inserts aid movement and breathability. Two side zipped pockets. Heat transfer PUMA Cat branding on left leg. Regular fit. dryCELL.

100% polyester-double knit-finish.

Start:05/01/2021
End : Spring 2025

**STYLE
NUMBER**

MSRP*

Men's (S-XXL)

657249

\$30

Col

Description

03

Puma Black-Puma White

06

Peacoat-Puma White



03



06

SS21

076863
TeamGOAL wheel Team bag XL
\$90



01
Black

072376
Team bag sack
\$40



01
Black

072375
Team Messenger bag
\$60



01
Black



SIDELINE

TEAM LIGA 25 Padded Jacket

Padded jacket with hood. Elasticated cuff. Full length coil zip .
Two side zipped pockets. PUMA cat logo on right chest.
Regular fit.

100% Polyester-twill-down proof.

Start:05/01/2021
End : Spring 2025

STYLE
NUMBER

MSRP*

Men's (S-XXL)

657265

\$90

Youth (M-XL)

657266

\$90

Col

Description

03

Puma Black-Puma White

06

Peacoat-Puma White

SS22

06



03



TEAM LIGA 25 All Weather Jacket

Light weight water repellent jacket , with fold away hood .
Mesh inner aids breathability.
Bold main color blocking on front and back with contrast black sleeves.
Reversed full coil zip. Two side zipped pockets.
Heat transfer PUMA Cat branding on right chest. Regular Fit.

100% nylon

Start:05/01/2021
End : Spring 2025

STYLE
NUMBER

MSRP*

Men's (S-XXL)

657245

\$55

Youth (M-XL)

657246

\$55

Col

Description

01

Puma Red-Puma Black

02

Electric Blue Lemonade-Puma Black

03

Puma Black-Puma White

02



01



03



SS22

TEAM GOAL 23 Casuals Hoody

PUMA Cat logo embroidery on right chest; hood with drawcord channel for an adjustable fit. Pouch front pocket. Rib cuffs and hem. Regular fit.

32% polyester, 68% cotton-terry-280.00 g/m²

Start:01/20/2020 End : Spring 2024	STYLE NUMBER	MSRP*
Men's (S-3XL)	656580	\$60
Youth (S-XL)	656711	\$50

Col	Description
01	Puma Red
02	Electric Blue Lemonade
03	Puma Black
06	Peacoat
33	Medium Gray Heather

SS22



Men's United Blank Tee

Classic short-sleeve blank tee.

100% Cotton

Available:Now	STYLE NUMBER	MSRP*
YS-YXL , S-XXL	892785	\$14

Col	Description
01	White
02	Gray
03	Black
04	Red
05	Navy
06	Royal Blue
07	Forest

02



01



03



04



05



06



07



SS22

Men's United Long Sleeve Top

Classic long-sleeve blank crew neck cotton shirt.

100% Cotton

Available:Now	STYLE NUMBER	MSRP*
YM-YXL , S-XXL	892786	\$18

Col	Description
01	White
02	Gray

02



01

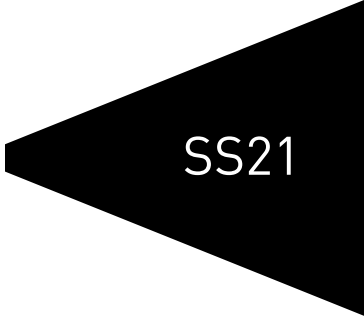

SS21

LIGA Beanie

PUMA Cat embroidered on front panel. One size fits all. Design allows an optimum logo placement. The material mix of polyester and elastane allows you perfect conditions during training session. Perfect breathability and fit.

90%polyester 10%Elastane

Start:02/01/18

End :

STYLE
NUMBER

MSRP*

OSFA

022355

\$15

Col

Description

01

Puma Red-Puma Black

02

Electric Blue Lemonade-Puma Black

03

Puma Black-Puma White

01



SS22

02



03



LIGA Reversible Beanie

PUMA Cat embroidered on front. One size fits all. Design allows an optimum logo placement. Reversible Beanie.

100% Polyester

Start:02/01/18
End :

**STYLE
NUMBER**

MSRP*

OSFA

022357

\$18

Col

Description

03

Puma Black



SS22

LIGA Cap

PUMA cat print on right panel. Heat transfer print in contrast color on the center of the visor. Lower surface of visor in contrast color. Design allows an optimum logo placement. PUMA wording on inner panels.

100% cotton

Start:02/01/18 End :	STYLE NUMBER	MSRP*
OSFA	022356	\$15

Col	Description
03	Puma Black



SS22



384139 01
LEADCAT 2.0
Puma Black-Puma White
\$25



384139 02
LEADCAT 2.0
Puma White-Puma Black
\$25



384139 04
LEADCAT 2.0
Peacoat-Puma White
\$25



384151 01
LEADCAT 2.0 STRAP
Puma Black-Puma White
\$35



387201 01
LEADCAT 2.0 WOMENS
Puma Black-Puma White
\$25



387201 02
LEADCAT 2.0 WOMENS
Puma White-Puma Black
\$25



387199 01
LEADCAT 2.0 STRAP WOMENS
Puma Black-Puma White
\$30



384434 01 / 384435 01
LEADCAT 2.0 JR / PS
Puma Black-Puma White
\$20



384434 03 / 384435 03
LEADCAT 2.0 JR / PS
Peacoat-Puma White
\$20

KING 21 IT
MSRP \$70



106696 01
Sizes 7 -12



LAUNCH: NOVEMBER 15, 2021



EQUIPMENT

083236
FINAL 21.1 (FIFA Quality Pro ball)
\$110



01
Puma white-
Rubine red-rising
teal-puma black-
clear sky



03
Lemon tonic-
Spectra green-
rising teal-puma
black-clear sky

083304
FINAL 21.2 (FIFA Quality Pro ball)
\$60



01
Puma white-
Rubine red-rising
teal-puma black-
clear sky



03
Lemon tonic-
Spectra green-
rising teal-puma
black-clear sky

083456
FINAL 21.3 (FIFA Quality ball)
NHFS
\$40



01
Puma white-
Rubine red-rising
teal-puma black-
clear sky

083457
FINAL 21.3 (FIFA Quality ball) size 4
NHFS
\$40



01
Puma white-
Rubine red-rising
teal-puma black-
clear sky

083311
FINAL 21.6 MS Ball
\$20



01
Puma white-
rubine red-rising
teal-puma black



02
Puma white-
Puma red-Puma
black



03
Puma white-
Electric blue
lemonade

083408
Futsal 1 FIFA QUALITY PRO
\$50



01
Puma white-
Digital blue-Fizzy
orange-Elektro
green

083410
Futsal 1 Trainer MS ball (3,4)
\$22



01
Puma white-
Digital blue-Fizzy
orange-Elektro
green



02
Elektro green-
Digital blue-
Luminous Pink



03
Fizzy yellow-
Puma black-blue
glimmer-
shocking orange

083236

teamFINAL 21.1 FIFA QUALITY Pro Ball

The TeamFinal 21.1 is a World class competition ball, which will be used by national clubs along with professional leagues around the world.

MSRP :\$110

The unique 8 panel configuration reduces the amounts of seams and creates larger panels for a surer touch.

The laminated PU + Rubber foam body combine to provide a stable rebound and high power return.

FIFA Quality Pro guarantees the ball is the highest of standards

Pro Performance outer texture with debossed grooves enhances the aerodynamics.



Rubber bladder with PAL (Puma Airlock) technology provides excellent air retention.

Thermo bonded construction provides excellent shape retention and minimal water uptake.

083304

teamFINAL 21.2 FIFA QUALITY Pro Ball

The teamFINAL21.2 is a top quality competition ball.

MSRP : \$60

The laminated PU outer + Rubber foam body combine to provide a stable rebound and excellent playability

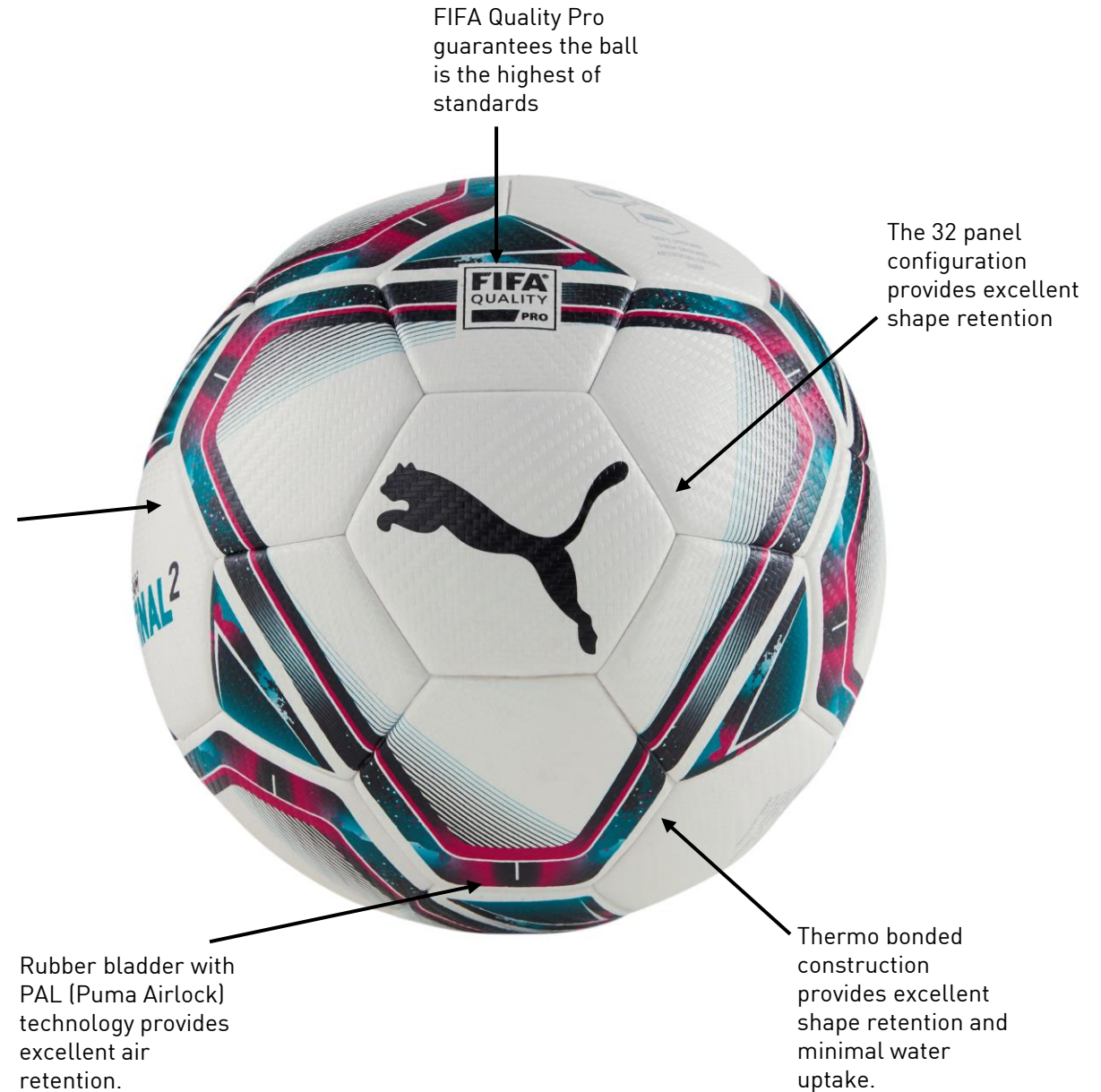

083456 teamFINAL 21.3 FIFA QUALITY Ball NFHS (size 5) 083457 (size 4)

The teamFINAL 21.3 is a high quality match ball for all conditions

MSRP : \$40

The unique 8 panel configuration creates larger panels for a surer touch.

The outer PU + laminated Rubber foam body provides a soft touch and a powerful return

FIFA Quality guarantees an excellent level of performance



Rubber bladder with PAL (Puma Airlock) technology provides excellent air retention.

Thermo bonded construction provides good shape retention, durability and minimal water uptake.

083408 01

FUTSAL 1 FIFA QUALITY PRO Ball

A top of the range Futsal match ball.

MSRP : \$50

FIFA Quality Pro guarantees the ball is the highest level of performance game after game.

High Frequency molded 32 panel for outstanding performance and durability.



Low rebound filled bladder for optimal control.

Panels are strengthened with EVA foam backing for enhanced stability.

TEAMWEAR LIFECYCLE

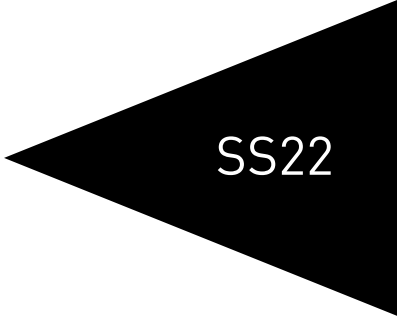

SS22

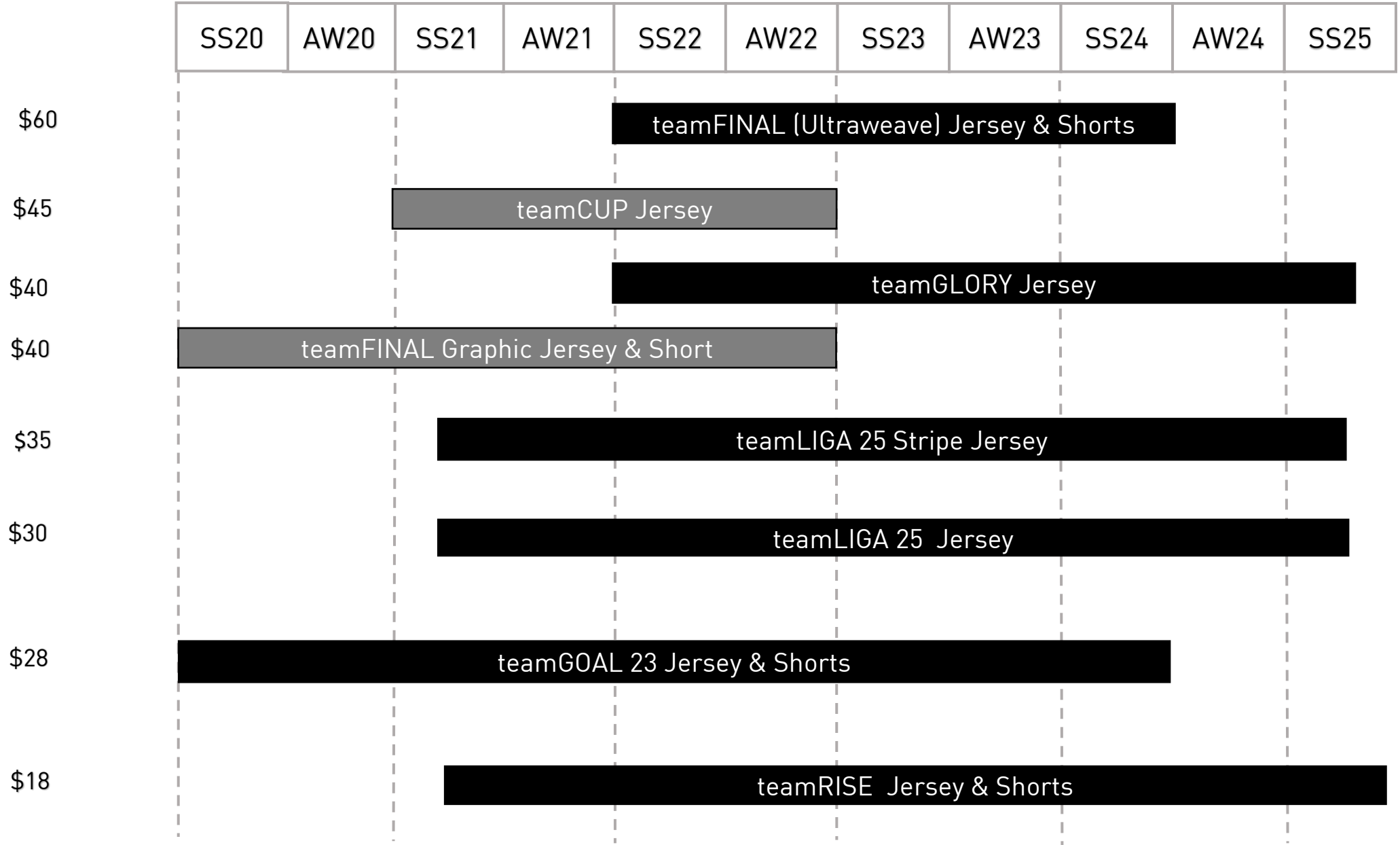

FOR MORE INFORMATION CONTACT YOUR REGIONAL SALES REPRESENTATIVE

Mike DeCesar	Key Account Manager	Soccer.com	(978) 394-7122	Michael.DeCesar@puma.com
Benjamin Reasner	Teamsport Manager	Team Sales West	(312) 758-2555	Benjamin.Reasner@puma.com
Keith Woods	Teamsport Manager	Team Sales East	(978) 337-1840	Keith.Woods@puma.com
Kevin Arcuri	Teamsport Rep	OH,MI,IN,KS,KY,TN,IL,MO,MN,NE,IA,SD,ND,WI	(937) 371-0869	
John Weires	Teamsport Rep	Northern CA , Northern NV, AK,HI,ID,MT,OR,UT,WA,WY	(916) 956-3135	
Brian Boyd	Teamsport Rep	Northern NJ , NY, New England	(773) 331-7877	
David Casarotte	Teamsport Rep	Southern CA , AZ,NM,NV	(310) 948-2452	
Paul Cervone	Teamsport Rep	AL,FL,GA,MS,NC,SC, Puerto Rico	(321) 303-0803	
Pete Knippenberg	Teamsport Rep	Eastern PA , DE,MD,DC, Southern NJ , VA,WV	(312) 259-9622	
Frank Rodriguez	Teamsport Rep	Southern (Los Angeles) and Central CA	(951) 454-0542	
Kyle Swords	Teamsport Rep	AR,CO,LA,OK,TX	(214) 789-6715	





FOREVER **FASTER.**